



62 Masefield Road

Wheatley Hills, Doncaster, DN2 5SY

Offers Over £135,000

Located in a popular area of Doncaster, this property conveniently lies with easy reach of local bus routes, Doncaster Royal Infirmary and local amenities. Brought to the market with NO ONWARD CHAIN, this 2 bedroom semi detached boast a conservatory to the rear. Comprises; hall, lounge to front, kitchen with French doors to conservatory, two bedrooms and a bathroom. Outside there is parking to the front, side access to rear garden with lawn and shed. Ideal first time buy or rental property.

- Ideal investment or first time buy
- No onward chain
- Sought after area close to Doncaster Royal Infirmary
- Lounge to front elevation
- Kitchen/dining room
- Sizeable conservatory to rear
- Parking to front
- Enclosed garden to rear
- Early viewing advised
- Freehold, council tax band A

Viewing

Please contact our Office on 01302 751616 if you wish to arrange a viewing appointment for this property or require further information.



Floor Plan

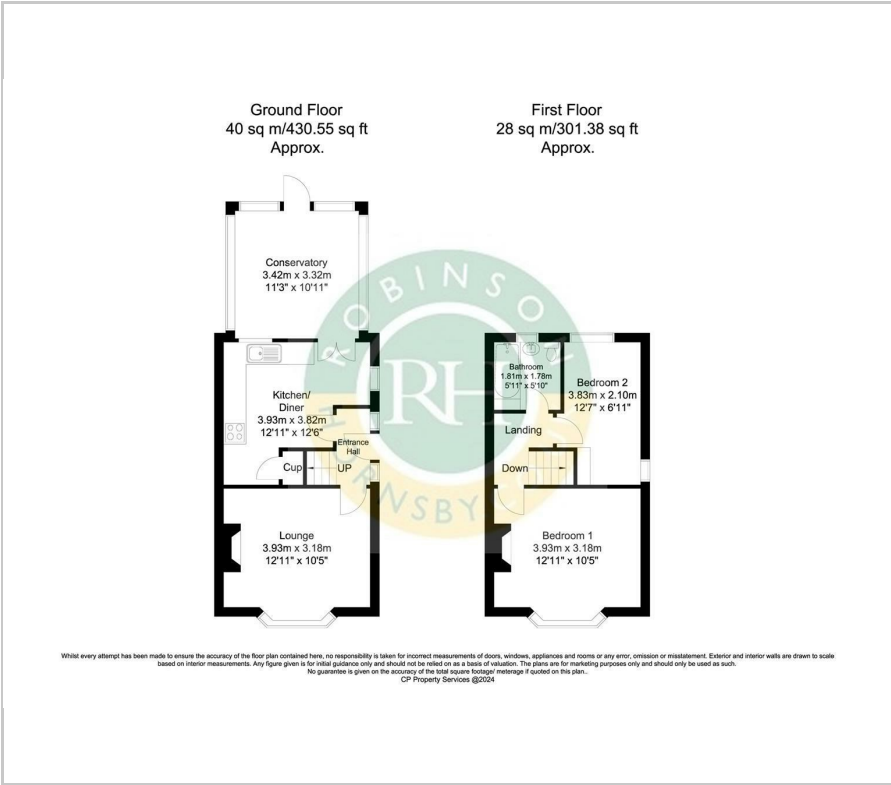

Area Map



Energy Efficiency Graph

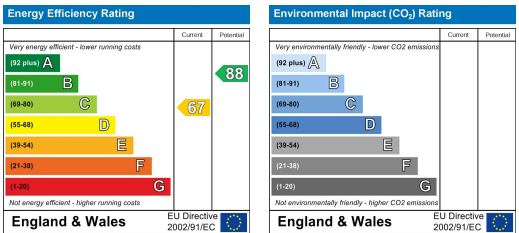

These particulars, whilst believed to be accurate are set out as a general outline only for guidance and do not constitute any part of an offer or contract. Intending purchasers should not rely on them as statements of representation of fact, but must satisfy themselves by inspection or otherwise as to their accuracy. No person in this firms employment has the authority to make or give any representation or warranty in respect of the property.